



FliteTop®

SIDEFLEXING CHAIN WITH RUBBER SURFACE

HF 882T SERIES - TAB, HEAVY DUY 57 mm HINGE

- Reinforced top plate thickness 4,8 mm.

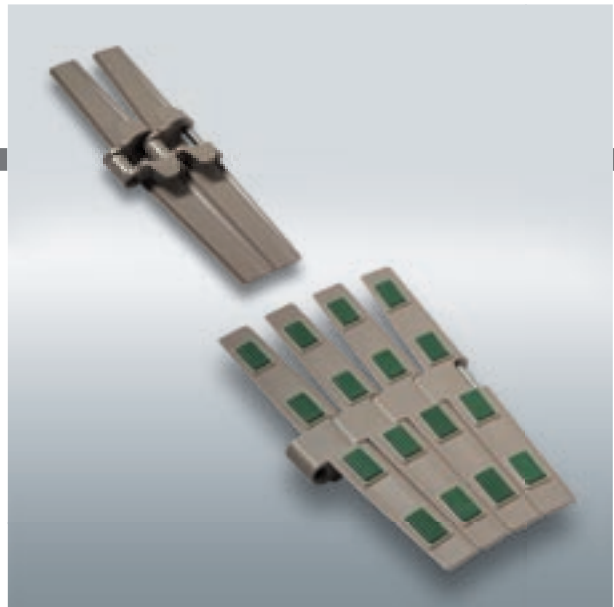

| Reference | Standard Materials |
|-----------|--------------------|
| HF 882T | LW |

Pad Material: Thermoplastic rubber (see page 62).
Pin Material: Cold rolled austenitic stainless steel.

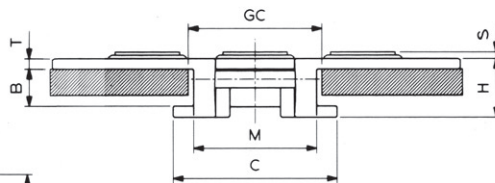
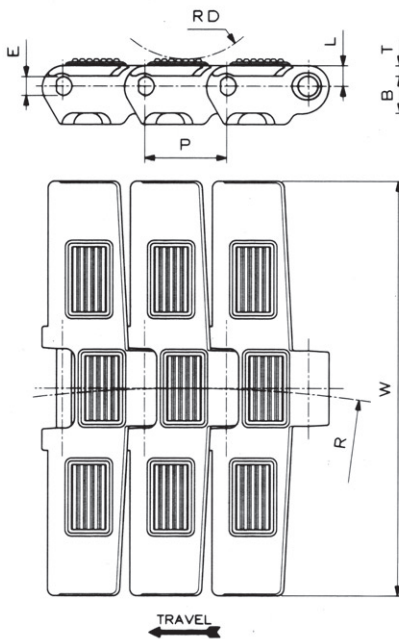

| Dimension | mm | inches |
|---------------|------|--------|
| P | 38,1 | 1.5 |
| M | 57 | 2.244 |
| C | 76 | 2.992 |
| L | 9,5 | .374 |
| H | 27,1 | 1.067 |
| E | 8,7 | .343 |
| B | 17 | .669 |
| S | 3 | .118 |
| V | 16 | .63 |
| Z | 30 | 1.181 |
| Y | 6 | .236 |
| RD | 40 | 1.575 |
| GC (Straight) | 60 | 2.362 |
| GC (Curve) | 60 | 2.362 |

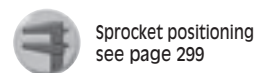
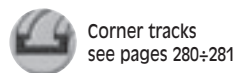
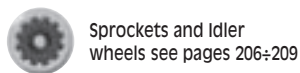
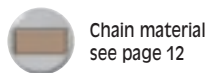
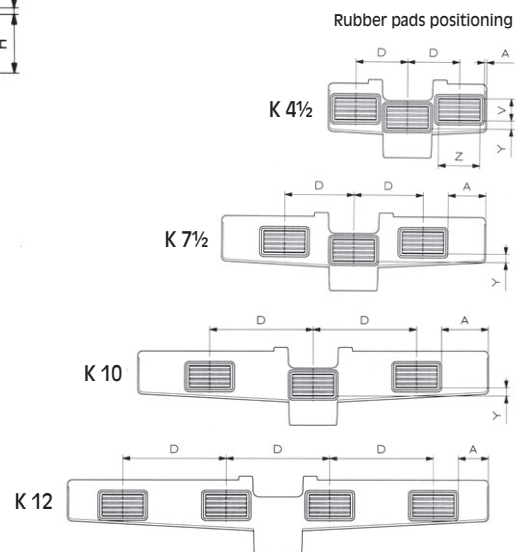

HF 882T (Sideflexing - Reinforced Top Plate Thickness - Heavy Duty 57 mm Hinge - Tab - Rubber Pad)

| MATERIAL | REGINA REF. | CHAIN WIDTH W | | PLATE THICKNESS T | | PADS PITCH D | | A | | SIDEFLEXING RADIUS R | | WORKING LOAD (25°C/77°F) | | CHAIN WEIGHT | |
|-------------------|--------------------|---------------|--------|-------------------|--------|--------------|--------|------|--------|----------------------|--------|--------------------------|-----|--------------|--------|
| | | mm | inches | mm | inches | mm | inches | mm | inches | mm | inches | N | lbs | kg/m | lbs/ft |
| ACETAL RESIN (LW) | HF 882T LW K 4 1/2 | 114,3 | 4.50 | 4,8 | 0.189 | 37,5 | 1.476 | 1,6 | 0.063 | 609,6 | 24 | 2800 | 630 | 2,17 | 1.46 |
| | HF 882T LW K 7 1/2 | 190,5 | 7.50 | 4,8 | 0.189 | 50,0 | 1.969 | 27,2 | 1.071 | 609,6 | 24 | 2800 | 630 | 2,59 | 1.74 |
| | HF 882T LW K 10 | 254,0 | 10.00 | 4,8 | 0.189 | 75,0 | 2.953 | 34,0 | 1.339 | 609,6 | 24 | 2800 | 630 | 2,88 | 1.94 |
| | HF 882T LW K 12 | 304,8 | 12.00 | 4,8 | 0.189 | 75,0 | 2.953 | 21,9 | 0.862 | 609,6 | 24 | 2800 | 630 | 3,17 | 2.13 |

Standard length: 3,048 m (10 feet)